

LAND USE PLAN  
 PUTHIA UPAZILA HEADQUARTERS  
 DISTRICT RAJSHAHI

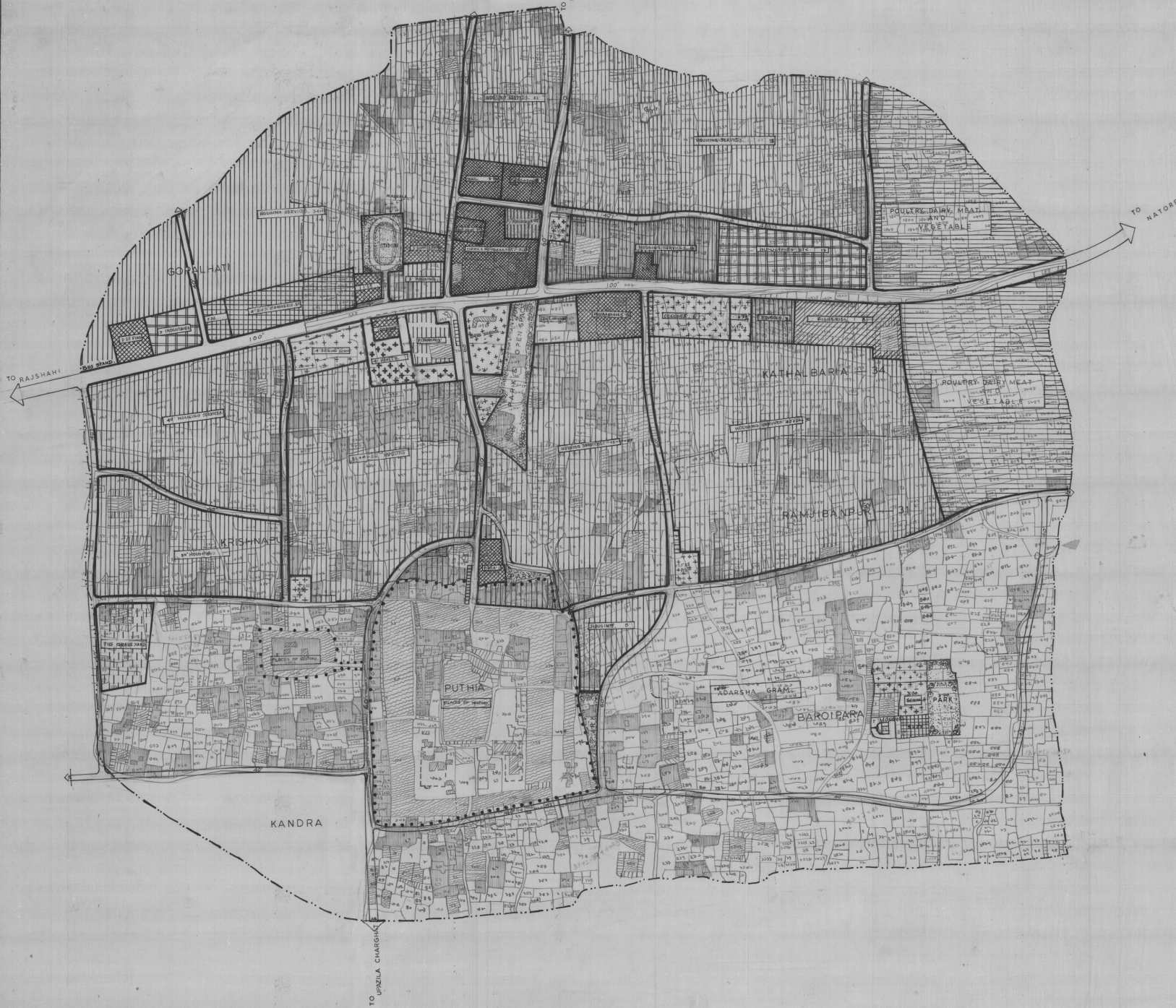
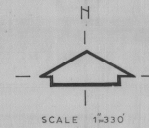

**LEGEND**

Code	Description	Area Sq.
1.	OFFICES (Upazila, Government, etc)	31.50
2.	HOUSING	
a.	Public Housing	4.75
b.	Private Housing	469.50
3.	CIVIC CENTRES	
a.	COMMERCE, ETC.	2.00
	Market	8.90
b.	Local shops	1.75
4.	EDUCATION AND TRAINING	
a.	Primary school	5.00
	Secondary school	12.50
c.	College	6.00
d.	Vocational Training	1.75
e.	Madrasa	0.50
5.	HEALTH, FAMILY PLANNING	6.00
6.	ROAD & SERVICE INDUSTRIES, WORKSHOP	16.00
7.	GROUNDS	6.25
8.	ADARSHA GRAM (Vegetable, Poultry, Meat, Dairy, Milk, Sweets etc)	151.00
9.	POULTRY, DAIRY, MEAT, VEGETABLE	90.00
10.	POND FISHERIES DEVELOPMENT	67.50
11.	PLAQUE OF HISTORY & ARCH. INTEREST	64.00
12.	RECREATION	
a.	Parks, Open Space	18.25
b.	Stadium	3.95
c.	Cinema	2.00
13.	GRAVEYARD	9.00
14.	TRANSPORTATION	
a.	Bus Stop, Cab/Rickshaw Parking	1.75
b.	Roads	201.25
15.	URBAN DEFERRED AGRI	50.25
16.	MOUZA BOUNDARIES	
17.	STUDY AREA	

LAND USE PLAN  
 PUTHIA UPAZILA HEADQUARTERS  
 DISTRICT RAJSHAHI

URBAN DEVELOPMENT DIRECTORATE  
 MINISTRY OF WORKS  
 GOVT. OF THE PEOPLES REPUBLIC OF BANGLADESH

DRAWN BY - SN. AHMED  
 TRACED BY - M.H. MOUZA & MD. A. KARIA

DATE - 24.6.1984  
 DRAWING NO.

M.K. KHORSHED ALAM  
 SENIOR PLANNER  
 URBAN DEV. DIRECTORATE

DATE 24/6/84  
 DIRECTOR-IN-CHARGE  
 URBAN DEV. DIRECTORATE